

Belangrijke aanwijzingen

Important notes

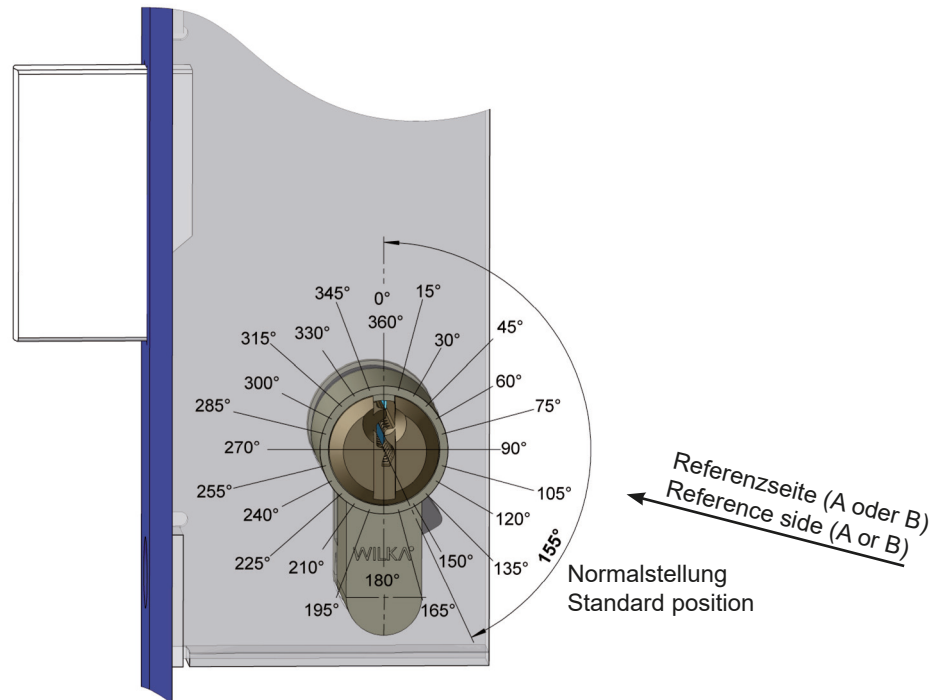

Sluitbaardstand

Standaard profielcilinder:

- Sluitbaardstand 155°
- Rechts en links toepasbaar

Artikel 1410, 2110, 3610:

- 8-voudig instelbare sluitbaard (in stappen van 45°-graden)

Speciale uitvoeringen van de art.-nrs. 1400, 1481, 1488, 2122, 2181, 2188 3600, 3681, 3688:

- Sluitbaardstand naar keus leverbaar
- Sluitbaardstand (aantal graden, zie tekening) en referentiezijde (A of B) opgeven a.u.b.

Cam position:

Standard profile cylinder:

- Cam position 155°
- Suitable for right and left

Article 1410, 2110, 3610:

- Adjustable cam for 8 positions (in steps of 45°)

Special designs of

Art. No. 1400, 1481, 1488, 2122, 2181, 2188 3600, 3681, 3688:

- Any cam positions available
- Please specify cam position (angle: see drawing) and reference side (A or B)

Belangrijke aanwijzingen

Using details

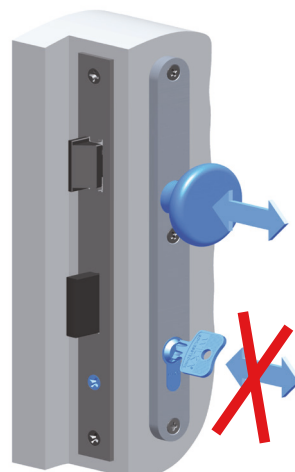
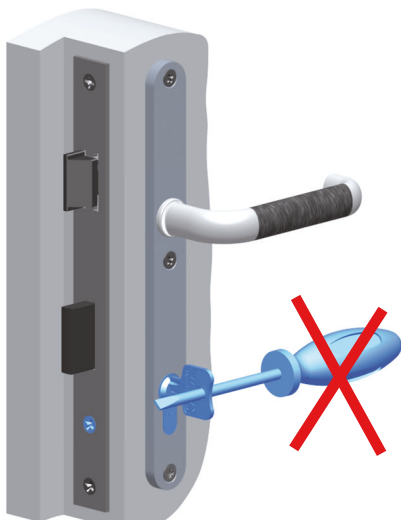
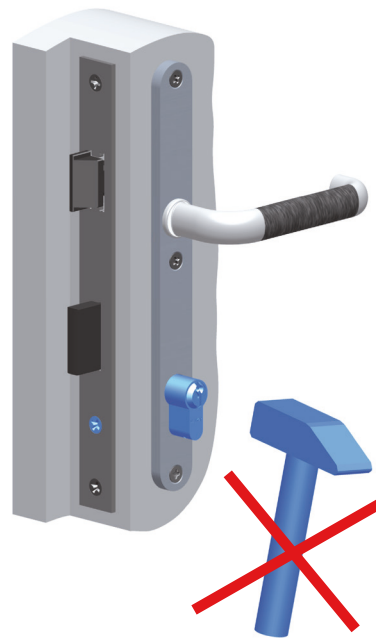
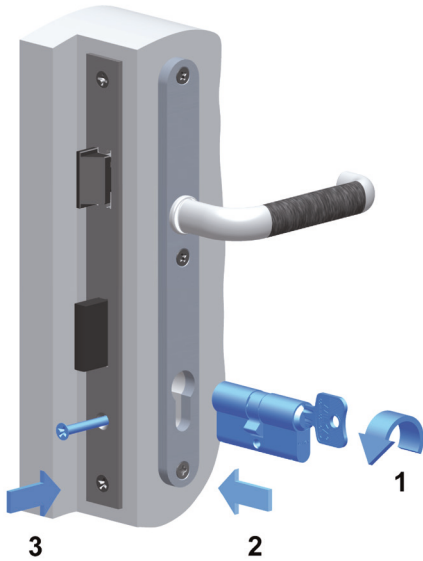
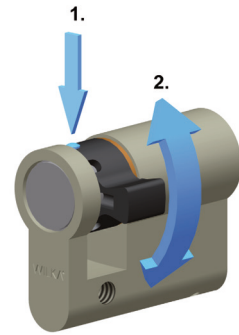
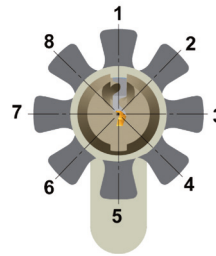
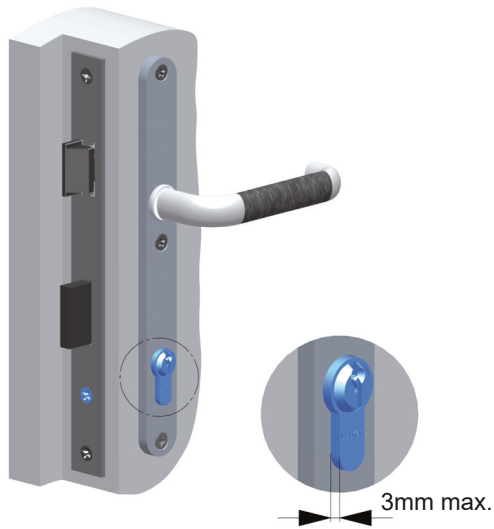

Belangrijke aanwijzingen

Using details

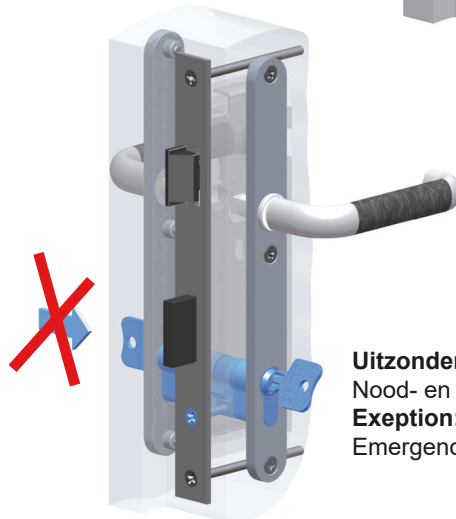
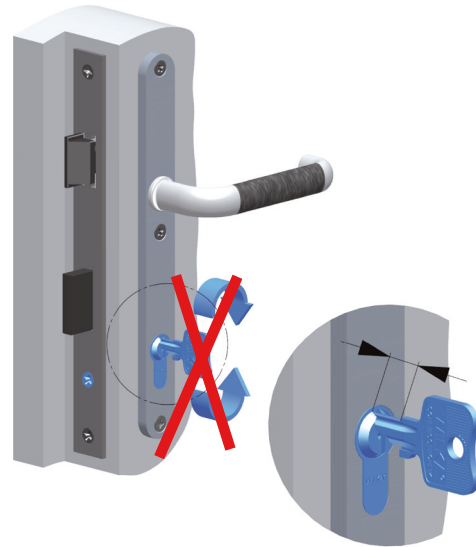
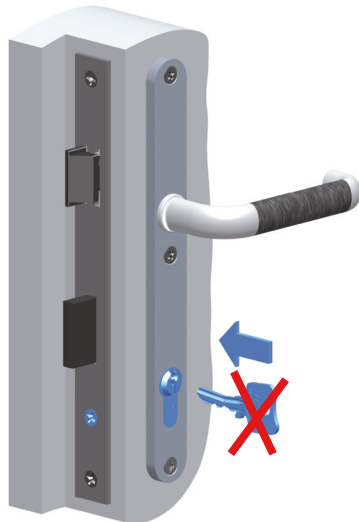

Uitzondering:
Nood- en gevaarfunctie
Exception:
Emergency exit function



2x jaarlijks
twice a year

Let op: Grafiet en spray
niet combineren!
Attention: do not combine
graphite and spray!

AEMA-Cleaner

of/or

grafiet/graphite (niet bij
standaard cilinders / **not
for standard cylinders**)